

## MORSE TAPER COLLET CHUCK ER (MTB PULL TYPE) DIN 228-A

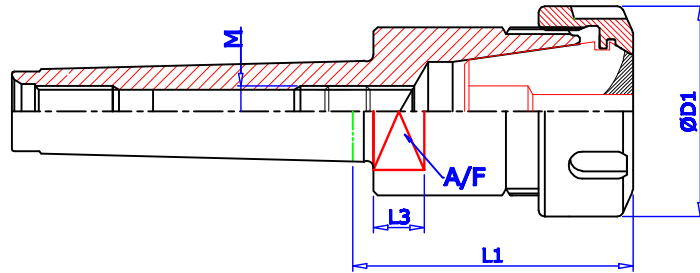

Maximum runout of MOUNTING taper to INTERNAL taper 0.005mm

COLLET CHUCK DESIGNATION	Ø D1	L1	M	A/F	L3	CLAMPING CAPACITY.	SUITABLE COLLET.	SUITABLE SPANNER.
MT1 ER11 025G.P	19	25	M6	-	-	0.5 - 7	ER 11	GS 17
MT1 ER16 045G.P	28	45	M6	-	-	0.5 - 10	ER16	GS25
MT2 ER16 042G.P	28	42	M6	-	-	0.5 - 10	ER16	GS25
MT2 ER20 048G.P	34	48	M8	-	-	1 - 13	ER20	GS30
MT2 ER25 052G.P	42	52	M10	-	-	1 - 16	ER25	E 25
MT3 ER25 052G.P	42	52	M12	24	12	1 - 16	ER25	E 25
MT3 ER32 070G.P	50	70	M12	24	12	2 - 20	ER32	E 32
MT3 ER40 080G.P	63	80	M16	24	12	3 - 26	ER40	E 40
MT4 ER25 052G.P	42	52	M12	32	15	1 - 16	ER25	E 25
MT4 ER32 054G.P	50	54	M12	32	15	2 - 20	ER32	E 32
MT4 ER40 075G.P	63	75	M16	32	15	3 - 26	ER40	E 40
MT4 ER50 105G.P	78	105	M16	32	15	10 - 34	ER50	E 50
MT5 ER40 082G.P	63	82	M16	45	18	3 - 26	ER40	E 40
MT5 ER50 100G.P	78	100	M16	45	18	10 - 34	ER50	E 50

Ordering Example :- MT3A ER25 052 -2 Nos

## MORSE TAPER COLLET CHUCK ER (MTA TANG TYPE) DIN 228-B

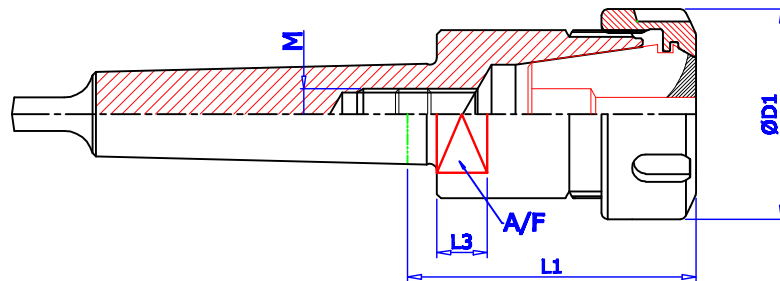

Maximum runout of MOUNTING taper to INTERNAL taper 0.005mm

COLLET CHUCK DESIGNATION	Ø D1	L1	M	A/F	L3	CLAMPING CAPACITY.	SUITABLE COLLET.	SUITABLE SPANNER.
MT1 ER11 025G.P	19	25	M6	-	-	0.5 - 7	ER 11	GS 17
MT1 ER16 045G.P	28	45	M6	-	-	0.5 - 10	ER16	GS25
MT2 ER16 042G.P	28	42	M6	-	-	0.5 - 10	ER16	GS25
MT2 ER20 048G.P	34	48	M8	-	-	1 - 13	ER20	GS30
MT2 ER25 052G.P	42	52	M10	-	-	1 - 16	ER25	E 25
MT3 ER25 052G.P	42	52	M12	24	12	1 - 16	ER25	E 25
MT3 ER32 070G.P	50	70	M12	24	12	2 - 20	ER32	E 32
MT3 ER40 080G.P	63	80	M16	24	12	3 - 26	ER40	E 40
MT4 ER25 052G.P	42	52	M12	32	15	1 - 16	ER25	E 25
MT4 ER32 054G.P	50	54	M12	32	15	2 - 20	ER32	E 32
MT4 ER40 075G.P	63	75	M16	32	15	3 - 26	ER40	E 40
MT4 ER50 105G.P	78	105	M16	32	15	10 - 34	ER50	E 50
MT5 ER40 082G.P	63	82	M16	45	18	3 - 26	ER40	E 40
MT5 ER50 100G.P	78	100	M16	45	18	10 - 34	ER50	E 50

Ordering Example :- MT3 B ER32 070 -2 Nos

All Details are subject to change without notice.