

DESCRIPTION	MOUNTING TAPERS 'K'	L1	L2	Ø D1	Wt.IN Kg.
0 - 6.5 : 0- 1/4"	B12 / J1 / J2a	61.5	68.0	34	0.290
1- 13 : 1/32"- 1/2"	B16 / J6	90.5	103.0	50	0.945

K	Ø D1	Ø d	L
B12	12.065	11.10	18.50
B16	15.733	14.50	24.0
J1	9.754	8.649	16.669
J6	17.170	15.852	25.400
J2a	13.940	12.386	19.050

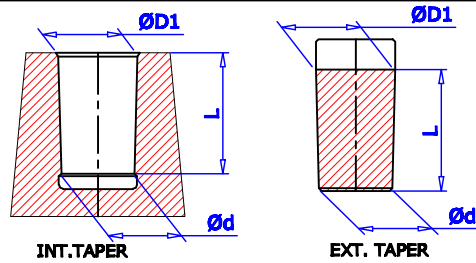

MORSE TAPER ADAPTORS FOR DRILLS (EXTRA LONG)

RUN OUT TESTING AS PER DIN-6349 PART 5

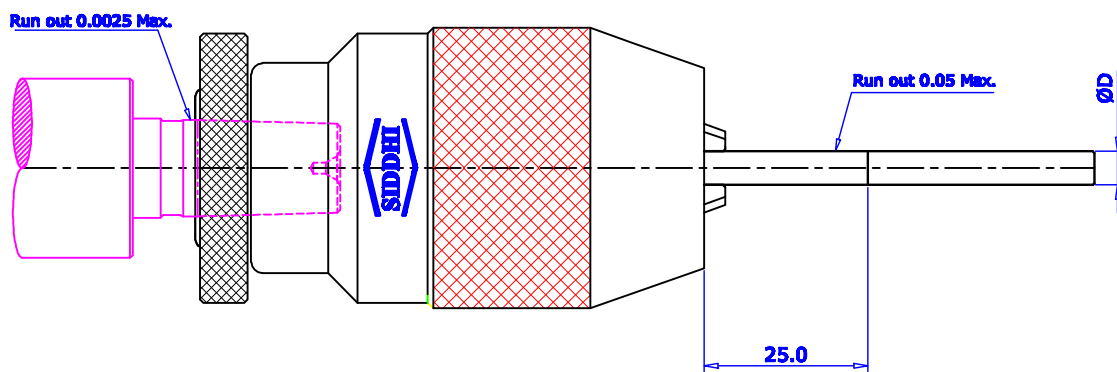

SIZE	Ø D
0.65	6
1.13	12